

PLASTIC & METAL REPAIR SYSTEM

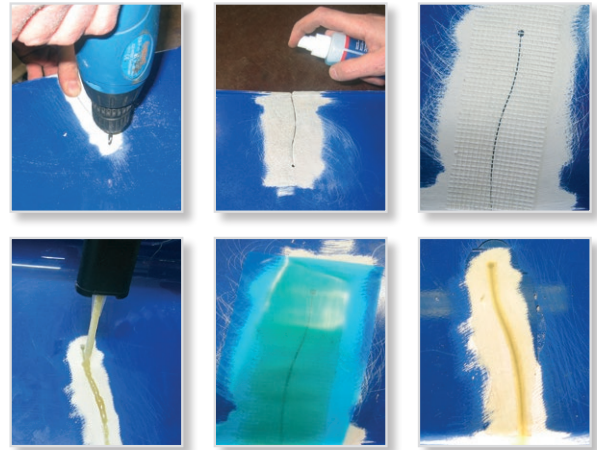

Plastic & metal repair system.



Properties:

- 100% liquid urethane
- Easy extrusion
- Wide temperature resistance -36°C to +100°C
- Thixotropic
- Possible to sand after only 10 minutes
- Clever extrusion gun
- Mixing nozzle contains only a minute amount of the product
- Workable like bodywork sealants
- Compatible with standard painting systems
- Flexible and durable just like the original part
- Long life of unopened individual cartridges – 1 year

Advantages:

- Guarantees perfect mixing and adhesion
- Easy and quick application
- Simple use at any place and time
- Does not trickle or drip, suitable even for overhead use
- Saves a lot of time
- Suitable also for a one-handed application
- Minimal waste
- No special tools needed
- Can be varnished
- Original-equivalent repair

Applications:

PLASTIC & METAL REPAIR SYSTEM is a complete system for repairing all kinds of plastics used in car bodywork, as well as all other maintenance operations. Cutting edge urethane technology allows the repairs of all types of plastic bumpers, grilles, plastic or metal hooks, and more.

Instructions for use:

1. Identify the type of plastic and use the enclosed table to select the appropriate type of repair sealant.
2. Roughen the repaired area and create a V-shaped groove if necessary.
3. Clean and degrease both sides of the repaired area using the attached **CLEANER** and dry with a clean cloth.
4. Apply the **PRIMER** (activator) on both sides and leave to dry (do not wipe off!)
5. Cut a piece of the attached blue plastic foil, large enough for a 3-4 cm overhang over the repaired area.
6. Insert the appropriate cartridge into the extrusion gun, hold vertically and push a little bit out until both components are extruded equally.
7. Affix the mixing nozzle onto the cartridge.
8. Apply a sufficient amount of the sealant needed for the repair into the middle of the plastic foil.
9. Apply the substance from the foil onto the back of the repaired area within 50 seconds and push it through the hole to the front of the repaired area.
10. Apply the substance immediately on the front as well.
11. Carefully place the plastic foil on the front side, ensuring the desired product coverage.
12. At a temperature between 20-25°C, the foil can be removed after 10 minutes.
13. Afterwards, the product is workable by all the usual means.
14. When finished, the product is suitable to be coated by a RETECH contouring or shining spray. The substance is compatible with any varnishing method.

ONLY FOR PROFESSIONAL AND INDUSTRIAL USE!

Technical data:

	RIGIT	CLEAR	TPO	FLEX
Time to open	1 min			
Time to seal	5 min			
Time to full curing	240 min			
Temperature during curing	80°C (exothermic reaction)			
Hardness SHORE	80 D		70 D	
Tensile strength	22 N/mm ²		23 N/mm ²	
Elongation	15%		20%	
Dielectric strength	1,2x10 ¹⁵ Ωxcm		4,8x10 ¹⁴ Ωxcm	
Temperature range	-36 °C to +100 °C			

Order codes:

Name	Storage code	Package	Volume / Size	Order number
Rigid	RRG	Double cartridge	50 ml	R 34376
Flex	RFX	Double cartridge	50 ml	R 34372
TPO	RTO	Double cartridge	50 ml	R 34374
Clear	RCR	Double cartridge	50 ml	R 34379
Cleaner	RCN	Bottle	125 ml	R 34371
Primer	RPR	Spray	200 ml	R 34375
PMR Tape	RRT	Roll	3,6 m	R 20080
PMR Backing Film	RBF	Roll	3,6 m	R 34370
Mixer	RMX	Bag	12 pcs	R 34373
Dispenser Gun	RDG		1 pc	R 34378

Health and Safety:

Please read our Material Safety Data Sheet.

Declaration:

The information and recommendations in this publication are to the best of our knowledge reliable. However nothing herein is to be construed as a warranty or representation. Users should make their own tests to determine the applicability of such information or the suitability of any products for their own particular purposes. Statements concerning the use of the products described herein are not to be construed as recommending the infringement of any patent and no liability for infringement arising out of any such use is to be assumed.

Address:

RETECH, s.r.o., Vackova 1541/4; Praha 5 - Stodůlky; Czech Republic
Contact address: 285 02 Suchdol u Kutné Hory cp. 212; tel./fax: +420 327 596 128; e-mail: info@retech.cz